

CF004a

## insulation below slab on ground/raft Dow Styrofoam RTM-X

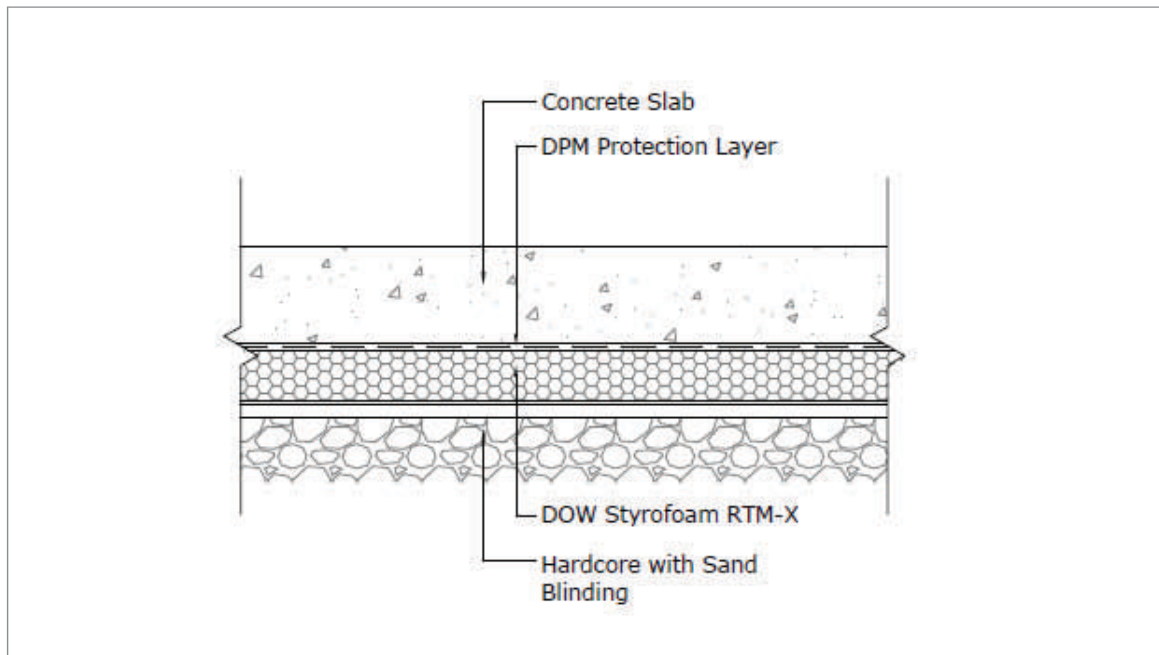

Preparation:	Confirm with a structural engineer for the required compressive strength required.
Installation:	Lay non-porous rigid board directly onto the levelled ground that will be under the slab, excluding footings and structural beams. Lay separating layer of polyethylene sheet above the Styrofoam RTM-X, lapping 100mm at joints.
Insulation:	Dow Styrofoam RTM-X
Total R-Value:	[Complete]

[Size] – Determined by required material R-value.  
30mm Dow Styrofoam RTM-X board will give R1.1 material /product only R-Value.  
Compressive strength needs to be considered by a structural engineer for dynamic and static loads.  
Follow structural engineers detail on raft slab detail.