

CF008a

below ground tanking system Dow Styrofoam RTM-X

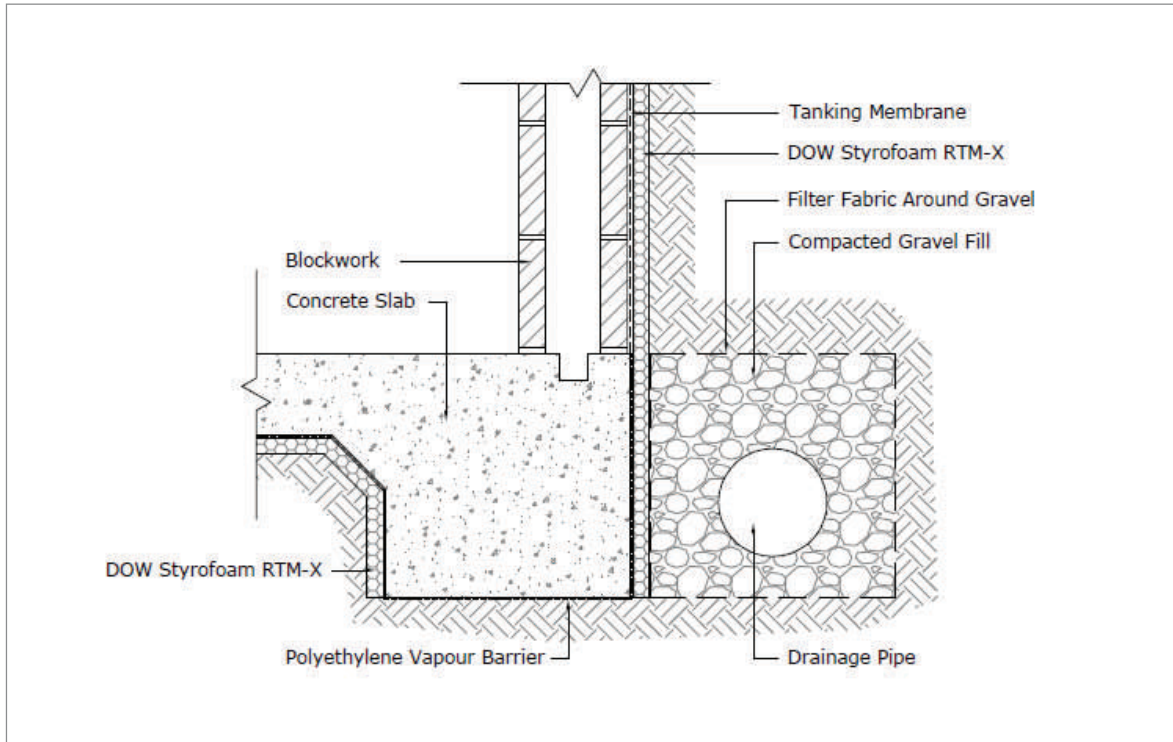

Location:	To masonry structure.
Material Insulation:	DOW Styrofoam RTM-X
Total R-Value:	[Complete]
Fixing:	Proprietary adhesive compatible to both the membrane and the Styrofoam RTM-X board.
Installation:	Lengthways with the tongue to the top edge and firmly against the inner masonry skin. Keep boards clean and dry and free from mortar and grout.